

THE HIGHLAND COUNCIL
 PLANNING & BUILDING STANDARDS AUTHORITY
 DATE: 14 June 2012
 Alex Planning & Building Standards Manager

RECEIVED
 PLANNING & BUILDING CONTROL
 LOCHSHEV
 17 JUN 2012

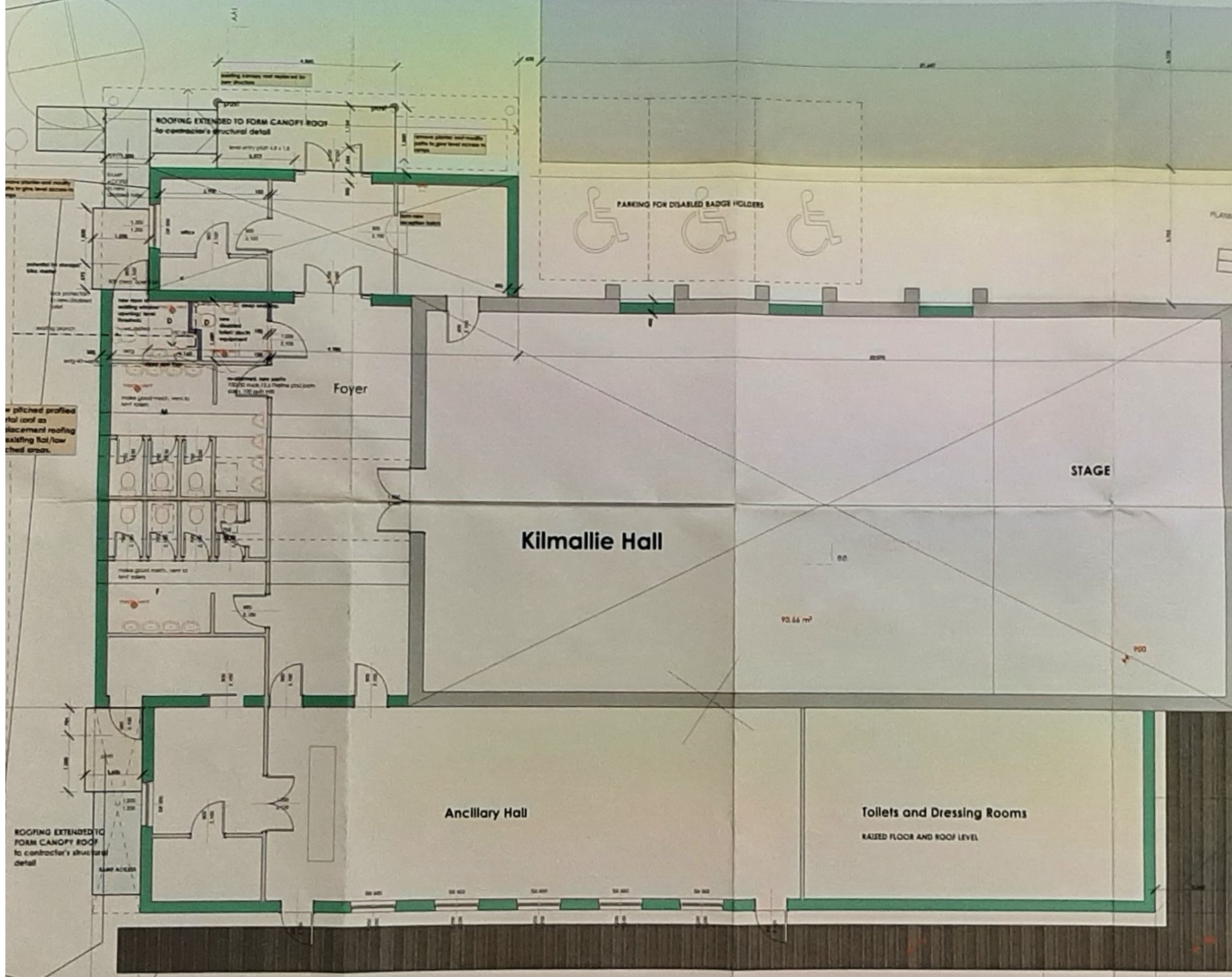

BIO MASS BOILER ENCLOSURE
 to HWE detail
 addition:
 secondary backup boiler
 Clyde Combuitions Ltd
 model 305/5
 70kw/
 200mm twin wall conventional flue,
 terminal at 1m ht above container roof level

David Mea-Architects
 CHARTERED ARCHITECTS

3 Cameron Square, Fort William PH12 6LH
 TEL: 01852 832222 FAX: 01852 832223

IMPROVING WORLD AT KILMALLIE
 FORT WILLIAM

KILMALLIE HALL COACHES

TENDER
 GENERAL REQUIREMENTS AND DETAILS

Scale: 1:50	Date:	Sheet: DM
Client Ref: K1005	Job No: DB/091	Draw No: 022

GROUND FLOOR PLAN