

- | | | |
|--|---|---|
|  Fire safety sign
fire door
keep locked |  Fire extinguisher
water type |  Fire extinguisher
carbon dioxide gas |
|  Fire safety sign
fire exit |  Fire extinguisher
fire blanket | |
|  Fire precautions
smoke resisting |  Fire precautions
pushbar door
ironmongery | |
|  Emergency lighting
self-contained |  Emergency lighting
exit sign
internally illuminated | |

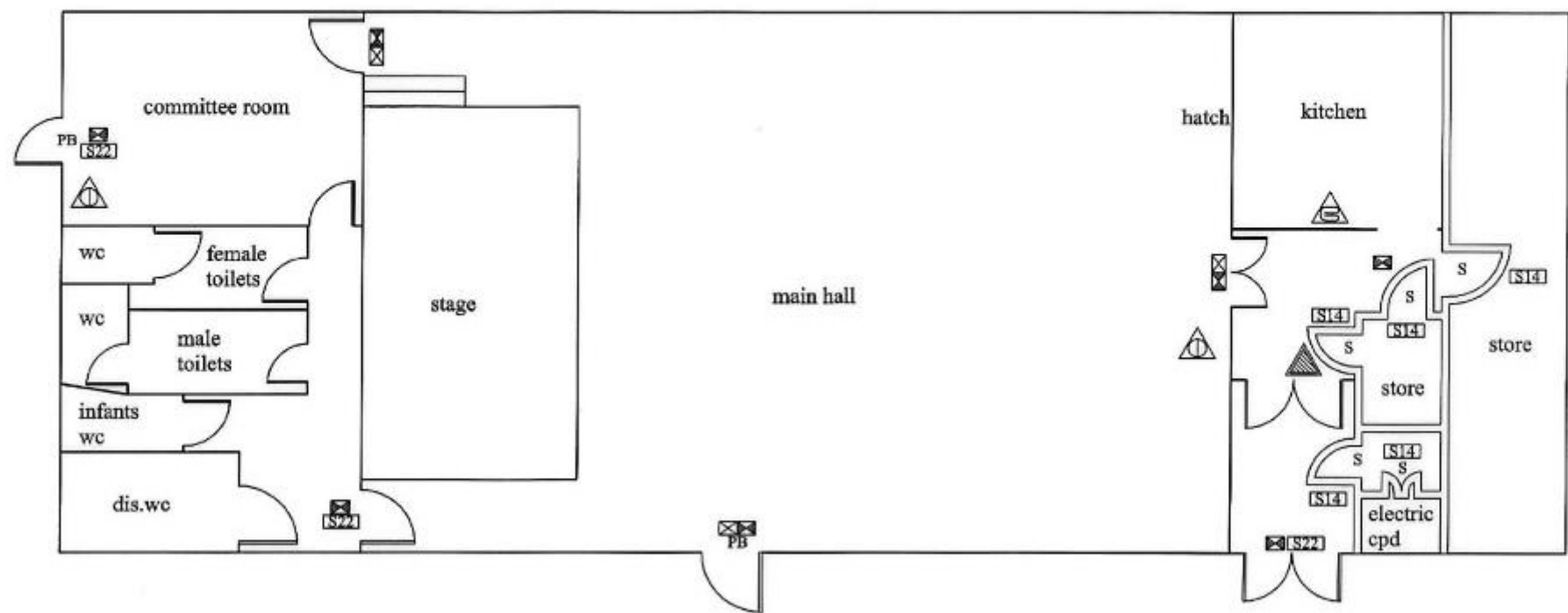

LOCAL GOVERNMENT (MISCELLANEOUS PROVISIONS) ACT 1982
 MAXIMUM NUMBER OF PERSONS THAT CAN BE SAFELY ACCOMMODATED IS : 130